



WORK BENCH



# Cut List:

Plywood / 3/4"   Grain Follows Length				
No.	Designation	Qty.	Finished	
			L	W
1	TableTop	1	96"	48"
2	TableBottom	1	86"	48"

Pine / 3 1/2" x 3 1/2"			
No.	Designation	Qty.	Finished
			L
3	TableLeg	4	27 1/4"

Pine / 3 1/2" x 1 1/2"			
No.	Designation	Qty.	Finished
			L
4	TopApronL	2	96"
5	LowerApron	2	93"
6	ApronW	9	45"



# Cut Diagram:

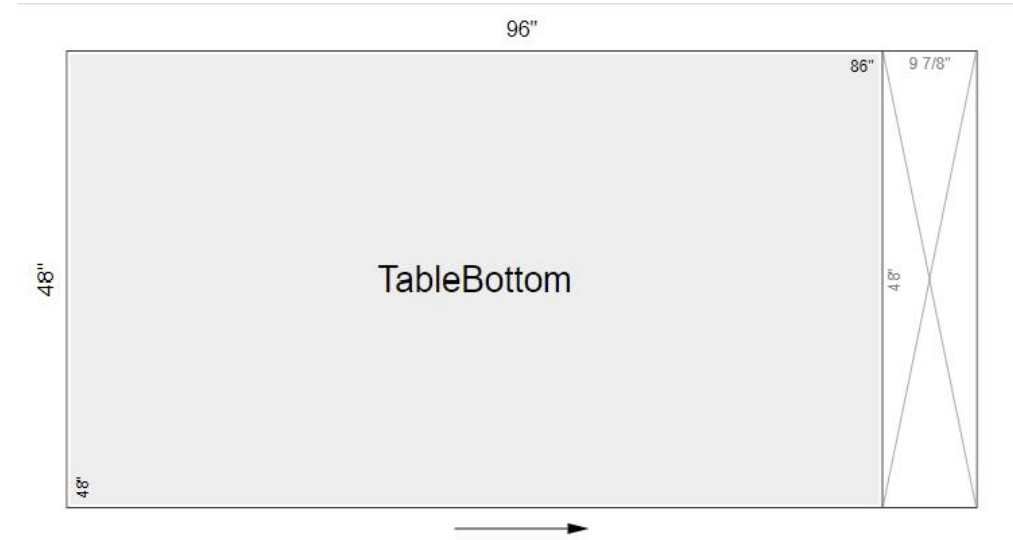
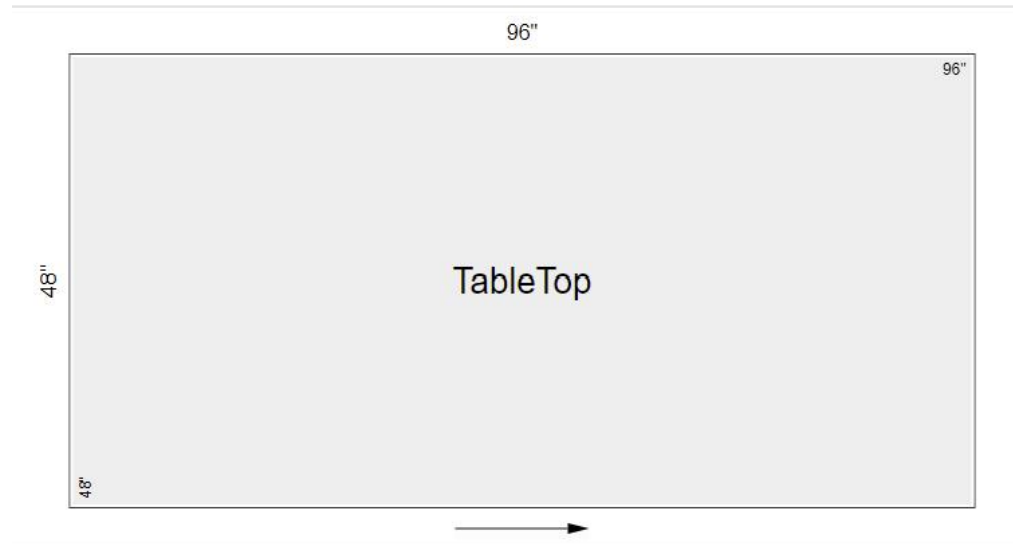



# Material List:

## Wood:

- 2 Sheets. 48in x9 6in x  $\frac{3}{4}$  in Paint Grade Plywood
- 2 Boards. Nominal 4 x 4 (3.5in x 3.5in) x 6ft standard Dimensional lumber
- 9 Boards. Nominal 2 x 4 (1.5in x 3.5in)x 8ft standard Dimensional lumber

## Hardware

- 4 pieces. 4inch High Caster Wheels
- #8 x 3 inch Long Standard Timber Screws



PARTS LIST		
ITEM	QTY	PART NUMBER
1	1	TABLETOP
2	1	TABLEBOTTOM
3	4	TABLELEG
4	2	TOPAPRONL
5	2	LOWERAPRON
6	9	APRONW
7	4	CASTER
8	60	3" FLAT HEAD SCREWS

Exploded View:

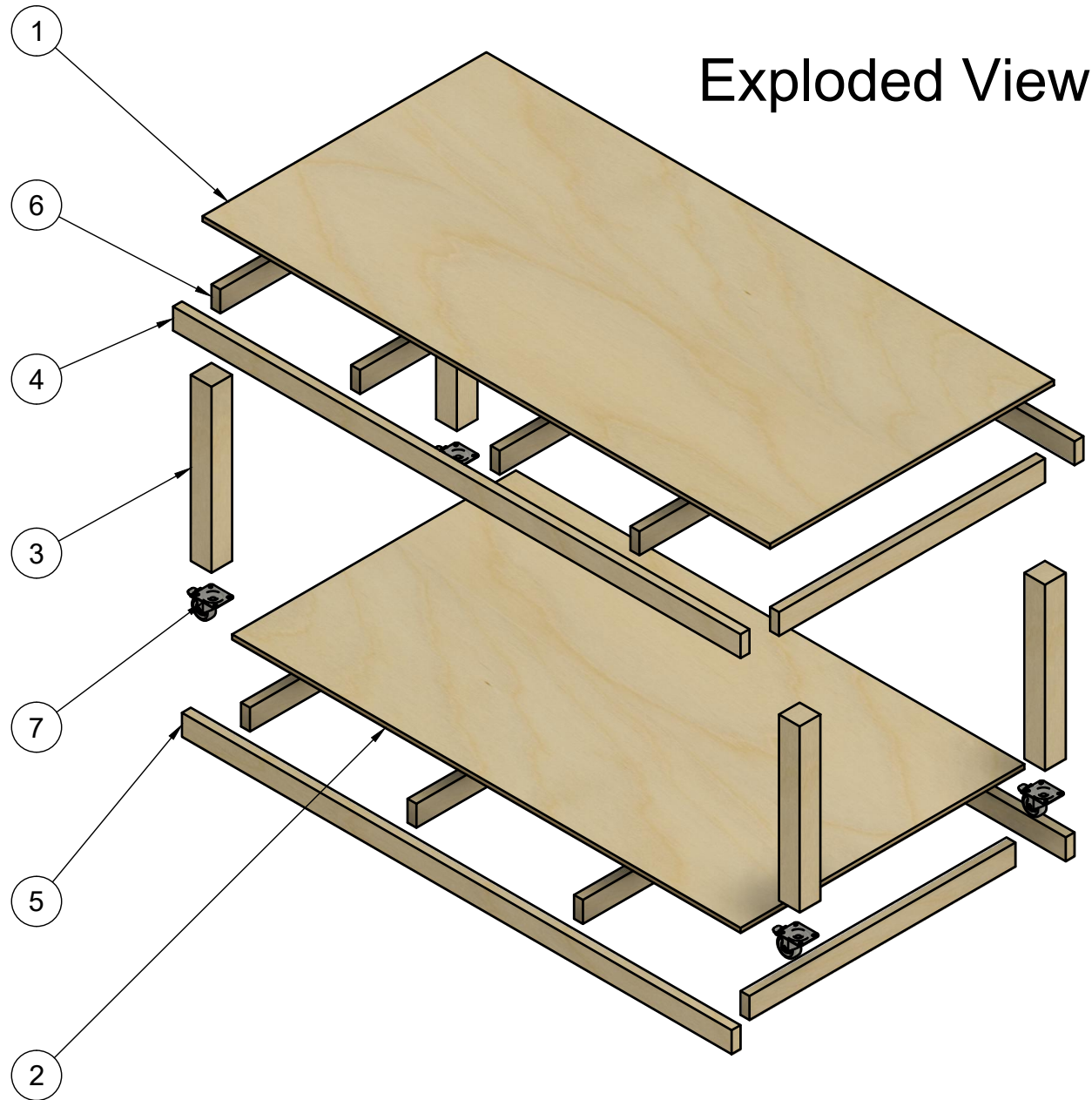



# BenchTop Assembly:

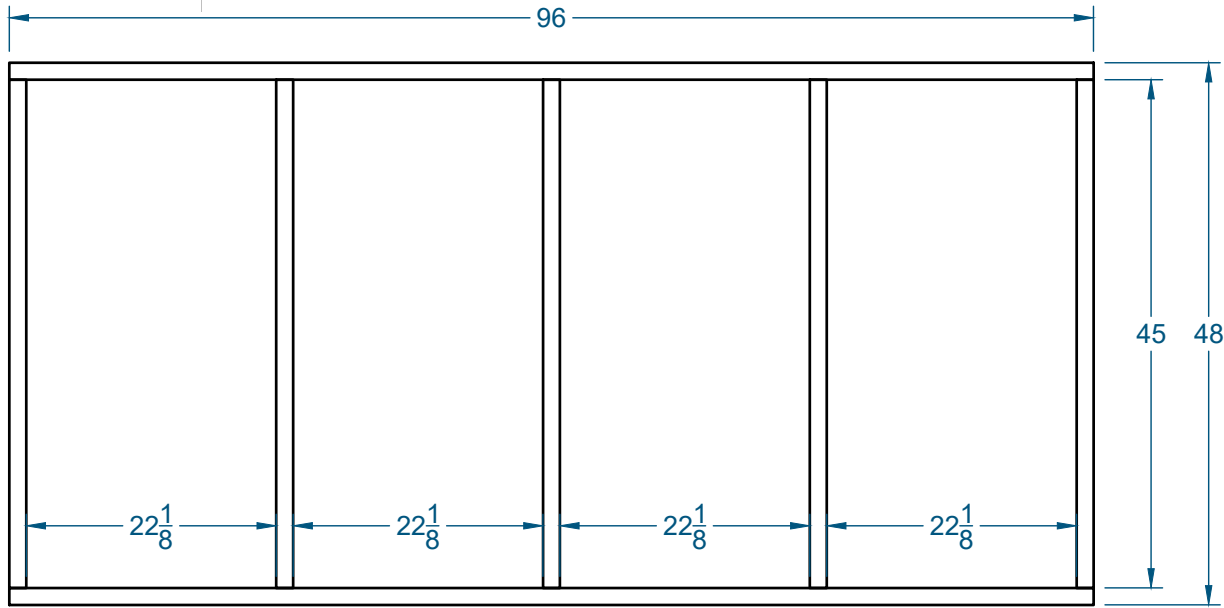

bottom view

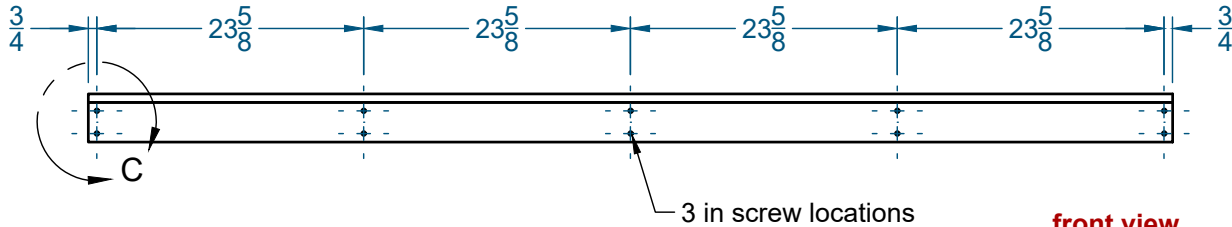
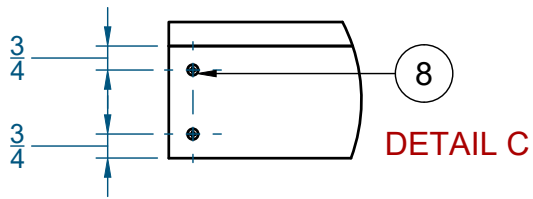

front view

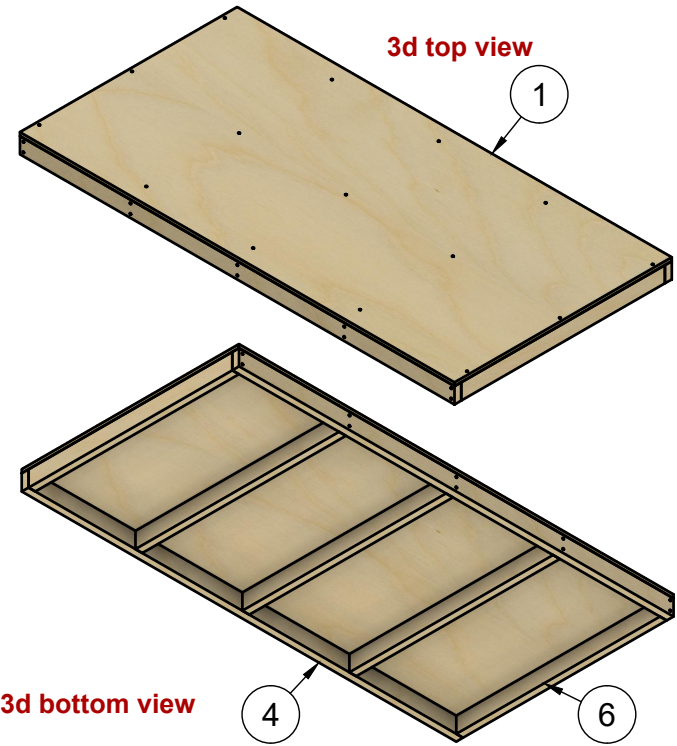

3d bottom view

PARTS LIST		
ITEM	QTY	PART NUMBER
1	1	TABLETOP
4	2	TOPAPRONL
6	5	APRONW
8	35	3" FLAT HEAD SCREWS



side view



# BenchTop Assembly:

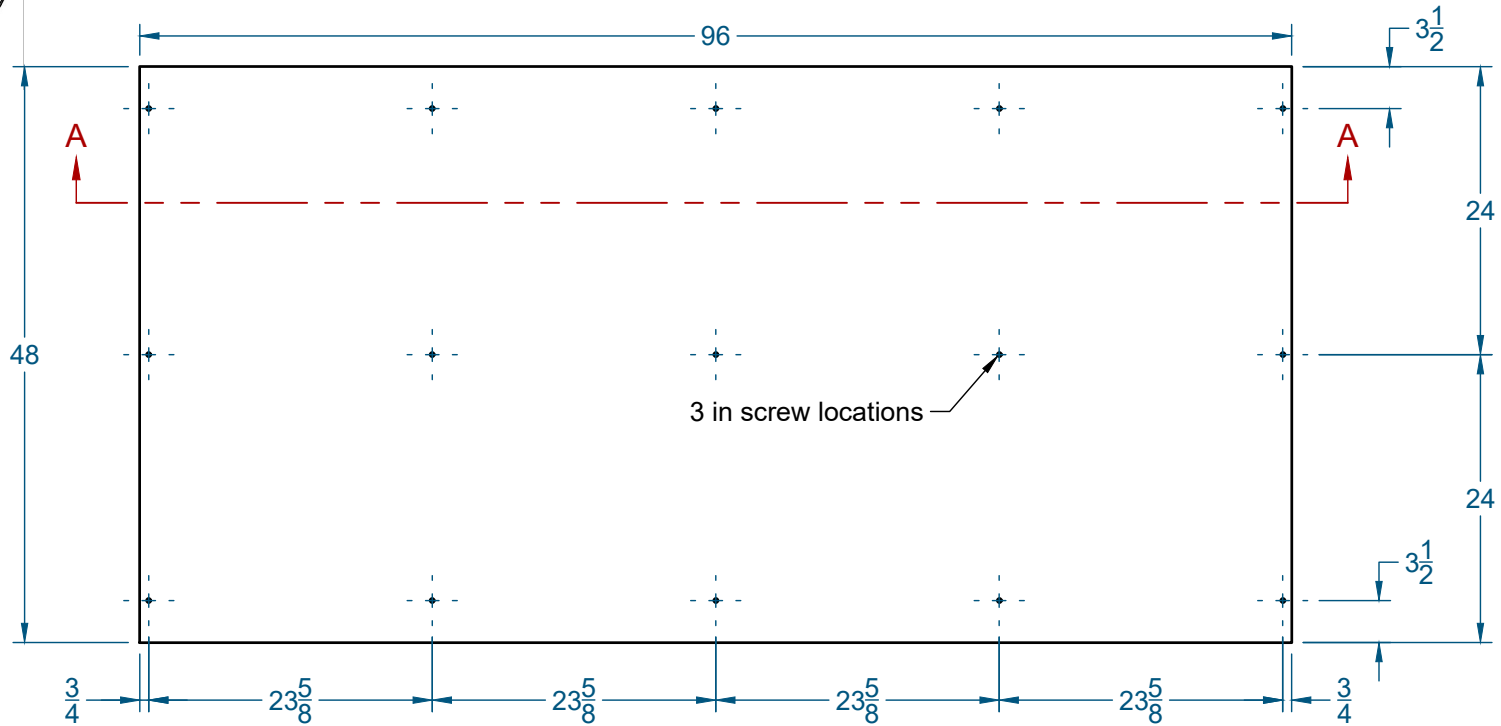

Top view

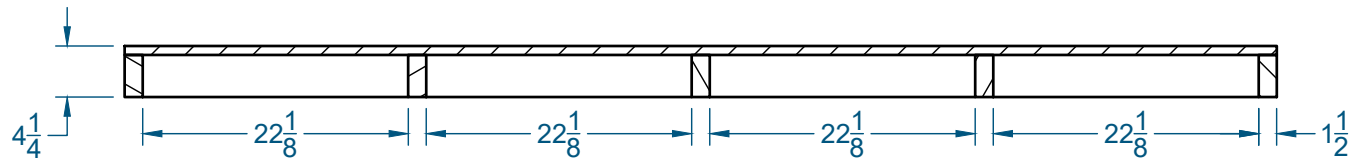

SECTION A-A



# BenchBottom Assembly:

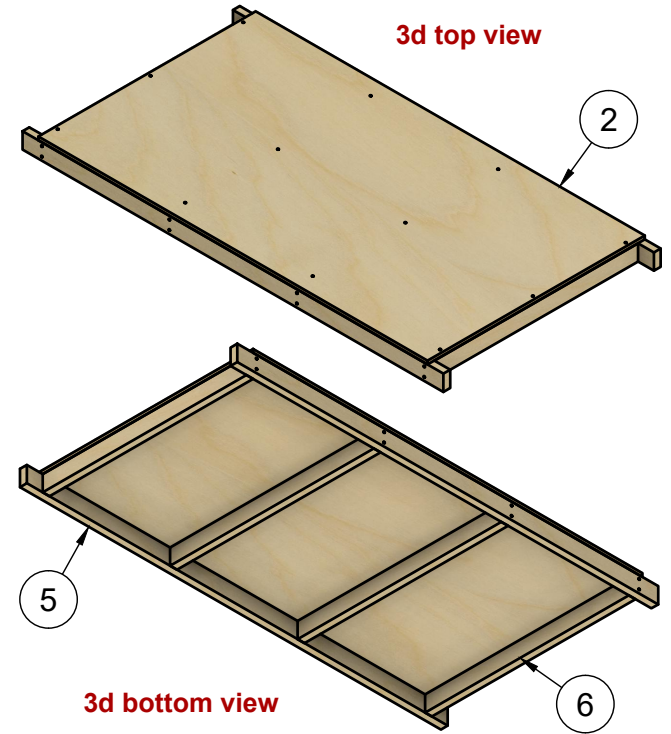
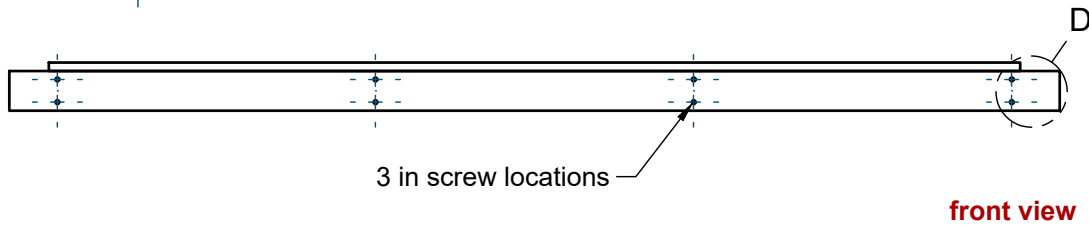
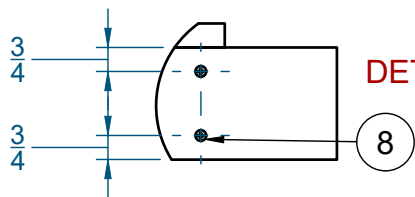
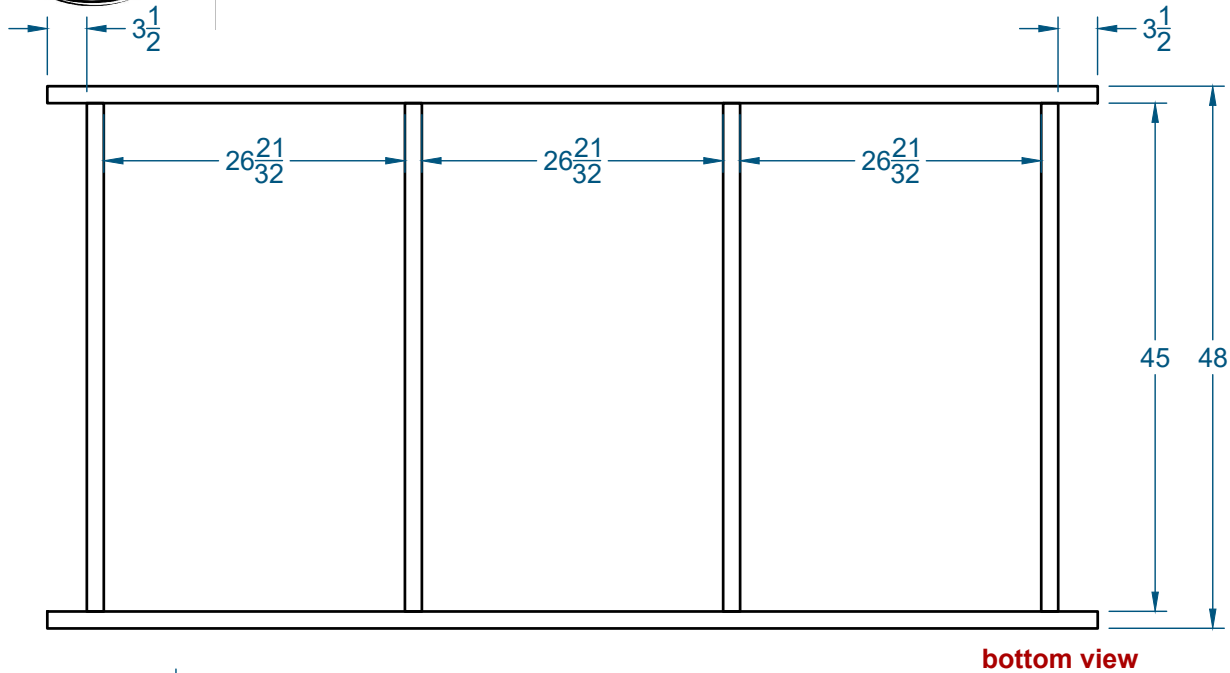

PARTS LIST		
ITEM	QTY	PART NUMBER
2	1	TABLEBOTTOM
5	2	LOWERAPRON
6	4	APRONW
8	28	3" FLAT HEAD SCREWS

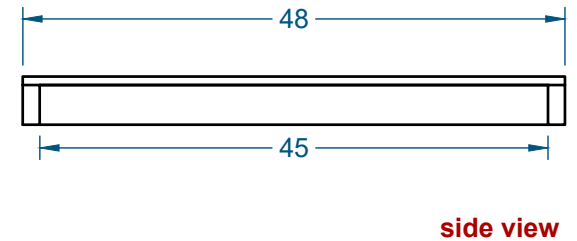







# Assembly:

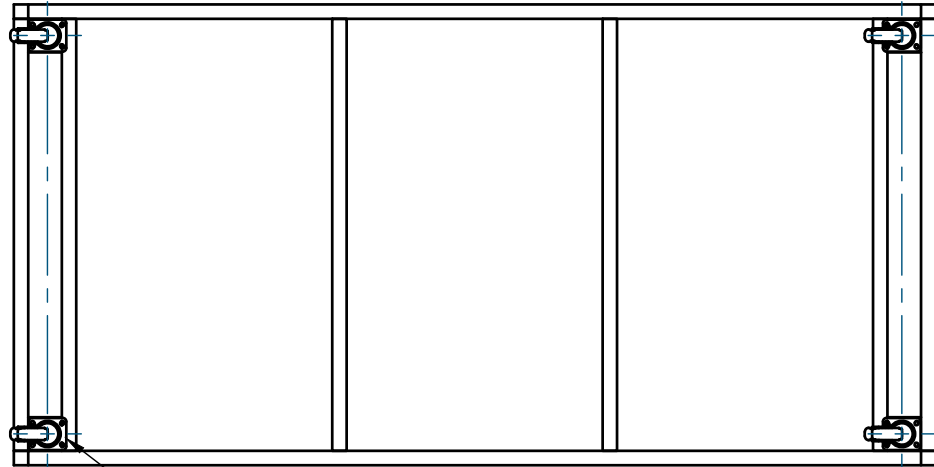
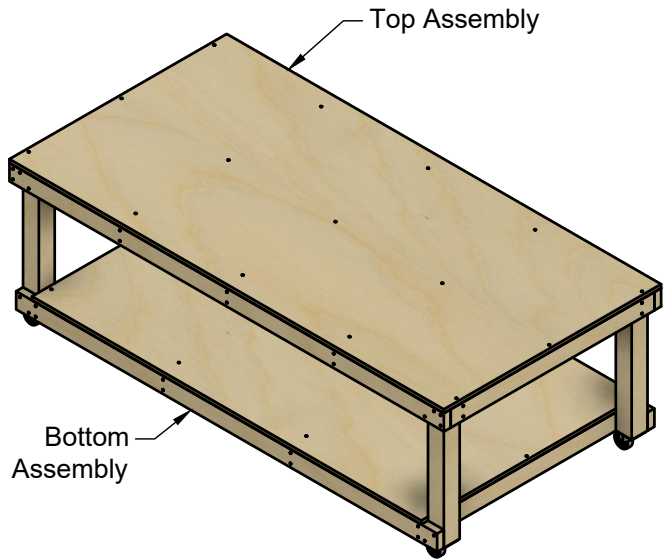

caster wheel locations

**bottom view**

